

BOARD OF SUPERVISORS MEETING

Meeting Notice

Tama County Board of Supervisors

Mon., Nov. 17, 2025

Meetings may also be available online for viewing and/or participating in by clicking the below link barring no power, internet, or equipment failure or other unforeseen circumstances. Meetings will still be held if there is no electronic availability.

[Click here to join meeting](#)

Agenda Schedule

** Agenda is not printed in any particular order, only time specific items will be addressed at certain times

8:30AM

Call to Order, Pledge of Allegiance

Approve agenda

Public comments-This time is set aside for public comments on County business topics. To be recognized raise your hand or stand. After recognition by the Chair, state your name and address. You may speak one time per issue. If the comment is for an item not on the agenda, please understand the Board of Supervisors will not act on your comments at this meeting due to the Open Meetings Law requirements but may do so at a future board meeting by placing it on the agenda. The Chair and Board members welcome comments from the public; however, all comments must be directed to the board and not others in attendance; keep your comments germane; it is not appropriate to use profane, obscene, or slanderous language. No personal attacks will be allowed. The Chair may limit each speaker to three minutes.

Discuss/Approve 11/10/25 regular minutes & 11/12/25 special minutes

Engineer-road projects report

Discussion/possible action to approve utility permit with USA Communications and authorize chairman to sign

Discussion/possible action to approve utility permit with Windstream Communications and authorize chairman to sign

Discussion/possible action to approve purchase agreement and easement documents on purchasing additional right of way from Peggy & Willis W Crees Family Trust on E29 Bridge replacement project no. BRS-C086(119)0-60-86 and authorize chairman to sign

Discussion/possible action to approve purchase agreement and easement documents on purchasing additional right of way from Larry & Victoria Holst on E29 Bridge replacement project no. BRS-C086(119)--60-86 and authorize chairman to sign

Discussion/possible action to approve purchase agreement and easement documents on purchasing additional right of way from Kaleb Bidwell on I Ave replacement project BROS-C086(120)--8J-86 and authorize chairman to sign

Discussion/possible action to approve appointing Laura Kopsa to Civil Service Commission

Discussion/possible action to approve appointing Richard Arp to Board of Health

Discussion/possible action to amend Resolution 11-10-2025B Moratorium on Battery Storage in Tama County, IA

Discussion/approve claims

Public comments

Adjourn

Board of Supervisors Minutes
November 10, 2025

The Tama County Board of Supervisors met at 8:30 a.m. November 10, 2025. Present: 1st District Supervisor, Curt Hilmer; 2nd District Supervisor, David Turner; 3rd District Supervisor, Heather Knebel; 4th District Supervisor, Mark Doland and 5th District Supervisor, Curt Kupka. Also, Tama County Auditor, Karen Rohrs, and members of the public.

The Pledge of Allegiance was recited.

Motion by Turner, seconded by Kupka to approve the agenda. Discussion: None. All voted aye. Motion carried.

Public Comments: Public comments were heard from Roger Wacha. Public comment time closed at 8:34 am.

Motion by Knebel, seconded by Hilmer to approve the minutes of the November 3rd regular meeting. Discussion: None. All voted aye. Motion carried.

Ben Daleske, Tama County Engineer, joined the meeting via Teams to give his road projects report. He also had Final Plans for BRS-C086(119)—60—86 for the bridge replacement project on E29. Motion by Kupka, seconded by Turner to approve the Final Plans for BRS-C088(119)—60—86, the bridge replacement project on E29, and to authorize the Board to sign the approved plans. Discussion: None. All voted aye. Motion carried.

The Board met with Skip Lowe from North Risk Partners who gave a report on the county health plan.

Motion by Turner, seconded by Kupka to approve the auditor to submit an ad for county crop and pastureland bidding to the newspapers to be advertised in the month of December with bids accepted by January 12th. Discussion: None. All voted aye. Motion carried.

Tama County Treasurer would like approval from the Board to open a bank account at the State Bank of Toledo for the EMS funds being collected. Motion by Turner, seconded by Hilmer to approve the treasurer opening a bank account at the State Bank of Toledo for the EMS funds. Discussion: None. All voted aye. Motion carried.

Motion by Hilmer, seconded by Turner to authorize the following Tama County representatives as signers on the new EMS account with the State Bank of Toledo: Karen Rohrs, Auditor, Amanda Kriegel, Treasurer, and Sara Gilbert, Treasurer Tax Assistant. Discussion: None. All voted aye. Motion carried.

Motion by Hilmer, seconded by Knebel to approve the Annual Urban Renewal Report for Fiscal Year 2024-2025 as presented by the Auditor. Discussion: None. All voted aye. Motion carried.

Motion by Hilmer, seconded by Knebel to approve the following resolution regarding a moratorium on data mining and centers in Tama County, IA. Discussion: None.

RESOLUTION 11-10-2025A

Resolution for Immediate and Indefinite Moratorium on Data Mining and Centers in Tama County, IA

WHEREAS, the Tama County Board of Supervisors is vested with the authority to protect the public health, safety, and general welfare of the residents of Tama County

WHEREAS, The Tama County Board of Supervisors recognizes the increasing interest in the development of data mining and centers within Iowa and;

WHEREAS, There currently is no county ordinance governing the siting, construction, or operation of data mining and centers in Tama County and;

WHEREAS, Potential concerns have been raised regarding the impacts of data mining and centers on Agricultural resources, electricity infrastructure, water resources, and overall community character and;

WHEREAS, The absence of an ordinance and comprehensive plan may hinder the County's ability to manage these impacts in a manner that protects the public interest and the welfare of its residents and;

WHEREAS, It is in the best interest of Tama County and its residents to engage in a deliberate and informed process to establish appropriate regulations prior to permitting any new data mining and centers and;

WHEREAS, The Tama County Zoning Commission is the appropriate body to develop a comprehensive ordinance addressing the siting and regulation of data mining and centers;

NOW, THEREFORE, BE IT RESOLVED by the Tama County Board of Supervisors that:

- The Tama County Board of Supervisors hereby imposes an immediate and indefinite moratorium on the acceptance, review, approval, or permitting of any new data mining and center developments within Tama County, Iowa.
- This moratorium shall remain in effect until:
 - A comprehensive land use plan is adopted by Tama County; and
 - The Tama County Zoning Commission drafts and the Board of Supervisors enacts a data mining and center ordinance providing for the appropriate regulation, siting, and operation of data centers.
- The Tama County Zoning Commission is hereby directed to work on the development of a comprehensive data center ordinance.

Roll Call Vote: Hilmer, aye. Turner, aye. Knebel, aye. Doland, aye. Kupka, aye. Resolution passed and adopted this 10th day of November, 2025. Mark Doland, Chairman, Board of Supervisors. Karen Rohrs, County Auditor.

Motion by Turner, seconded by Kupka to approve the following resolution regarding a moratorium on battery storage projects in Tama County, IA. Discussion: None.

RESOLUTION 11-10-2025B

A Resolution Establishing an Indefinite Moratorium on Battery Storage Projects in Tama County

WHEREAS, the Tama County Board of Supervisors is vested with the authority to protect the public health, safety, and general welfare of the residents of Tama County; and

WHEREAS, the County currently lacks a specific ordinance or comprehensive regulatory framework governing the siting, development, and operation of battery storage projects; and

WHEREAS, the Board recognizes the need to develop an ordinance to address the unique characteristics and potential impacts of battery storage projects; and
WHEREAS, the preservation of Tama County's agricultural lands, rural character, and natural resources is of vital importance to the well-being and sustainability of the county; and
WHEREAS, the Board has identified concerns related to battery storage projects, including but not limited to fire hazards, safety risks, adequacy of emergency response preparedness, potential for environmental contamination, appropriate setbacks from properties and sensitive uses, and visual impacts on the landscape; and
WHEREAS, it is essential to balance the property rights of landowners with the County's responsibility to protect public health, safety, and welfare, and to ensure that any future battery storage projects are thoroughly evaluated and appropriately regulated and;
WHEREAS, The Tama County Zoning Commission is the appropriate body to develop a comprehensive ordinance addressing the siting and regulation of battery storage projects.
NOW, THEREFORE, BE IT RESOLVED by the Tama County Board of Supervisors as follows:

- The Board hereby establishes an indefinite moratorium on the acceptance, review, or approval of any applications or permits for new battery storage projects within Tama County, effective immediately upon adoption of this Resolution.
- This moratorium applies to all proposed battery storage facilities, regardless of size, technology, or location, that are not currently permitted or under construction as of the effective date of this Resolution.
- The moratorium shall remain in effect until:
 - A comprehensive land use plan is adopted by Tama County; and
 - The Tama County Zoning Commission drafts and the Board of Supervisors enacts a data center ordinance providing for the appropriate regulation, siting, and operation of data centers.
- The Tama County Zoning Commission is hereby directed to work on the development of a comprehensive data center ordinance.

Roll Call Vote: Hilmer, aye. Turner, aye. Knebel, aye. Doland, aye. Kupka, aye. Resolution passed and adopted this 10th day of November, 2025. Mark Doland, Chairman, Board of Supervisors. Karen Rohrs, County Auditor.

The Zoning Administrator, Laura Wilson, presented a Variance Approval from the Board of Adjustment for the Board of Supervisors to review per Iowa Code 335.10(2) for Canaday parcel 05.33.334.003. Motion by Turner, seconded by Kupka to approve the Board of Adjustment's Variance Approval. Discussion: None. All voted aye. Motion carried.

Motion by Turner, seconded by Kupka to approve the claims for payment as presented in the amount of \$222,342.99. Discussion: None. All voted aye. Motion carried.

Public Comments: Public comments were heard from Karen Murty, Stacey Zeman, Jim Smith, Jack Cooper. Public comment time closed at 9:57 am.

Motion by Knebel, seconded by Turner to adjourn the meeting. All voted aye. Motion carried. Chairman Doland adjourned the meeting at 9:58 am.

These minutes are intended to provide a summary of the discussions and decisions made during the Board of Supervisor meeting. For the most accurate and comprehensive record, please refer to the audio recording of the meeting that can be provided upon request at the auditor's office.

Board of Supervisors Minutes
November 12, 2025

The Tama County Board of Supervisors met at 9:00 a.m. November 12, 2025. Present: 1st District Supervisor, Curt Hilmer; 2nd District Supervisor, David Turner; 3rd District Supervisor, Heather Knebel; 4th District Supervisor, Mark Doland and 5th District Supervisor, Curt Kupka. Also, Tama County Auditor, Karen Rohrs.

The Pledge of Allegiance was recited.

Motion by Turner, seconded by Kupka to approve the agenda. Discussion: None. All voted aye. Motion carried.

The Board verified the results and checked the tally tapes from all the voting precincts.

Motion by Hilmer, seconded by Turner to approve the following resolution:

RESOLUTION 11-12-2025A

**CERTIFICATION (CANVASS) OF TAMA COUNTY ELECTION RESULTS,
2025 CITY/SCHOOL ELECTION**

WHEREAS, the CITY/SCHOOL ELECTION was held as prescribed by law on November 4, 2025, and

WHEREAS, the Board of Supervisors and ex-officio Board of Canvassers have canvassed the vote of said election in accordance with §50.24 of the *Code of Iowa*, now therefore

BE IT HEREBY RESOLVED that we, the undersigned members of the Board of Supervisors and ex-officio Board of Canvassers of Tama County, Iowa, do hereby certify the following TURNOUT REPORT and RESULTS in the CITY/SCHOOL ELECTION, held November 4, 2025, and that no obvious clerical errors were identified during the canvass.

Two thousand four hundred forty-three (**2,443**) people voted at the polls on election day.

Two hundred thirty-six (**236**) absentee ballots were accepted for counting.

A total of two thousand six hundred seventy-nine (**2,679**) people voted.

All races are for a term of four (4) years unless otherwise noted.

**CANDIDATES ELECTED BY THE VOTERS OF THE RESPECTIVE CITIES AND SCHOOLS
LOCATED WHOLLY WITHIN TAMA COUNTY:**

Chelsea Mayor: Craig Fortch*

Chelsea City Council: Amy Walters, Bruce Rhoads*

Clutier Mayor (two-year term): Linda Pearson

Clutier City Council (two-year term): Duane Parizek Jr., Shelley Kriz, Gregg Riese, Donald Hutchings, Dianna Cowan

Dysart City Council: Jenn Alpers, Lydia Goken, Steven Stoner

Elberon Mayor (two-year term): Scott Pippert

Elberon City Council: Rynonda Franzen, Judy Upah, Adam Glunz

Garwin Mayor (two-year term): Matt Deam

Garwin City Council: C. Ryan Collins, Keith Barloon*

Gladbrook Mayor (two-year term): Wayne Nekola

Gladbrook City Council: Roger D. Luehring, Gregory Westwater*, Andrew Brallier*

Lincoln Mayor (two-year term): H. Trent Wentzien

Lincoln City Council (two-year term): John Eden, Dale Meyer, Samuel Cahalan, Michelle Clark, Gaylen Brandt

Montour City Council: Ron Green, Kent Scheid*, Alan Kelley*

Tama City Council: Kristy Eisentrager, Chris Smith

Toledo Mayor (two-year term): Brian Sokol

Toledo City Council: Duane Pansegrau, Doug Ray, Cathy Cook

Traer Mayor (two-year term): Peter Armstrong Holden

Traer City Council: Aaron Mennenga, James Erhardt

Vining Mayor (two-year term): Jeff Vore*

Vining City Council (two-year term): Shaye Betz*, Ashton Dulin*, Daryl Bazal*, Janice Bazal*, Jim Griggs*

North Tama Director District 1: Seth Seda

North Tama Director District 2: David Calderwood

North Tama Director District 3: LeRoy D. Staker

North Tama Director District 4: Marty Dostal

*Write in Winner

Roll Call Vote: Hilmer, aye. Turner, aye. Knebel, aye. Doland, aye. Kupka, aye. Resolution passed and adopted this 12th day of November, 2025. Mark Doland, Chairman, Board of Supervisors. Karen Rohrs, County Auditor.

John Hall, President & CEO of Marshalltown Area Chamber of Commerce, and his team were present to discuss with the Board of Supervisors how Tama County could benefit working with them for economic development. Motion by Turner, seconded by Knebel to approve a letter of engagement with Marshalltown Area Chamber of Commerce for economic development in Tama County and to approve John Hall with Marshalltown Area Chamber of Commerce to bring a formal contract back to the Board of Supervisors. Discussion: None. All voted aye. Motion carried.

Public Comments: No public was present for comments.

Motion by Knebel, seconded by Turner to adjourn the meeting. All voted aye. Motion carried. Chairman Doland adjourned the meeting at 10:38 am.

These minutes are intended to provide a summary of the discussions and decisions made during the Board of Supervisor meeting. For the most accurate and comprehensive record, please refer to the audio recording of the meeting that can be provided upon request at the auditor's office.

Tama County Board of Supervisors - Weekly Engineer's Office Report

November 17th, 2025

We are working near 260th St. and B Avenue and south of E66 on V Avenue ditch digging.

Stockpiling rock in Chelsea this week and this past week.

On E43 (Duponda), this project is finished up, and I will be working on the project closeout for this project.

PCI is needing to finish up the dirt work for this project. This project should be opened in a couple of weeks.

Manatt's has finished the surface lift of asphalt on the main line. They will be working on driveway rock and shoulder rock this week.

Tractors have been sold. Ford went for \$3.2k and Deutz went for \$5k.

TAMA COUNTY UTILITY PERMIT APPLICATION

This is a Utility Permit Application for telecommunications, electric, gas, water and sewer utilities. The applicant agrees to comply with the following permit requirements. Compliance shall be determined by the sole discretion of the County Engineer as deemed necessary to promote public health, safety and the general welfare. These requirements shall apply unless waived in writing by the County Engineer prior to installation.

Applicant Name: USA Communications

Street Address: 312 Locust St NE

City, State & Zip Code: Blairstown IA 52209

Telephone Number: 319-454-6234

Contact Person: Chad LeFevere

1. Location Plan. An applicant shall file a completed location plan as an attachment to this Utility Permit Application. The location plan shall set forth the location of the proposed line on the secondary road system and include a description of the proposed installation.
2. Written or Verbal Notice. At least two working days prior to the proposed installation, an applicant shall file with the County Engineer a notice stating the time, date, location and nature of the proposed installation.
3. Inspection. The County Engineer shall provide a full-time inspector during all permitted work done by a third party contractor. The inspector shall have the right, during reasonable hours and after showing proper identification, to enter any installation site in the discharge of the inspector's official duties, and to make any inspection or test that is reasonably necessary to protect the public health, safety and welfare. The cost of providing this inspection service shall be paid by the permit holder upon submission by Tama County of a bill for such services. All requirements listed in 4. Requirements shall be met (less written exemptions) regardless of whom actually performs the work.
4. Requirements. The installation inspector shall assure that the following requirements have been met:
 - A) Construction signing shall comply with the Manual on Uniform Traffic Control Devices.
 - B) Depth – The minimum depth of cover shall be as follows:

Telecommunications....36"	Electric.....48"	
Gas.....48"	Water.....60"	Sewer.....60"

If the utility is installed in the road ditch and if the ditch has silted in above the original flowline, add the depth of silting to the "minimum depth" to obtain the required depth in a particular location.
 - C) The applicant shall use reference markers in the right of way ("R.O.W.") boundary to locate line and changes in alignment as required by the County Engineer. A permanent warning tape shall be placed one (1) foot above all underground utility lines.
 - D) All tile line locations shall be marked with references located in the R.O.W. line.
 - E) No underground utility lines shall cross over a crossroad drainage structure.
 - F) Residents along the utility route shall have uninterrupted access to the public roads. An all-weather access shall be maintained for residents adjacent to the project.
 - G) A joint assessment of the road surfacing shall be made by the applicant and the County Engineer both before and after construction. After construction, granular surfacing shall be added to the road by the applicant to restore the road to its original condition. After surfacing has been applied, the road surface shall be reviewed by the County Engineer (after the road has been saturated), to determine if additional surfacing on the roadway by the applicant is necessary.

- H) All damaged areas within the R.O.W. shall be repaired and restored to at least its former condition by the applicant or the cost of any repair work caused to be performed by the County will be assessed against the applicant.
- I) Areas disturbed during construction which present an erosion problem shall be solved by the applicant in a manner approved by the County Engineer.
- J) All trenches, excavations, and utilities that are knifed shall be properly tamped.
- K) All utilities shall be located between the bottom of the backslope and the bottom of the foreslope, unless otherwise approved in writing by the County Engineer prior to installation.
- L) Road crossings shall be bored. The minimum depth below the road surface shall match the minimum depth of cover for the respective utility. All entrances with culverts shall either be bored or, the utility shall be placed at least 24" below the bottom elevation of the culvert.

- 5. Non-Conforming Work. The County Engineer may halt the installation at any time if the applicant's work does not meet the requirements set forth in this Utility Permit.
- 6. Emergency Work. In emergency situations, work may be initiated by an applicant without first obtaining a Utility Permit. However, a Utility Permit must be obtained within fourteen (14) days of initiation of the work. All emergency work shall be done in conformity with the provisions of this ordinance and shall be inspected for full compliance.
- 7. County Infraction. Violation of this permit is a county infraction under Iowa Code section 331.307, punishable by a civil penalty of \$100 for each violation or if the infraction is a repeat offense a civil penalty not to exceed two hundred dollars for each repeat offense. Each day that a violation occurs or is permitted to exist by the applicant constitutes a separate offense.
- 8. Hold Harmless. The utility company shall save this County harmless of any damages resulting from the applicant's operations. A copy of a certificate of insurance naming this county as an additional named insured for the permit work shall be filed in the County Engineer's office prior to installation. The minimum limits of liability under the insurance policy shall be \$1,000,000.
- 9. Permit Required. No applicant shall install any lines unless such applicant has obtained a Utility Permit from the county Engineer and has agreed in writing that said installation will comply with all ordinances and requirements of the County for such work. Applicants agree to hold the County free from liability for all damage to applicant's property which occurs proximately as a result of the applicant's failure to comply with said ordinances or requirements.
- 10. Relocation. The applicant shall, at any time subsequent to installation of utility lines, at the applicant's own expense, relocate or remove such lines as may become necessary to conform to new grades, alignment or widening of R.O.W. resulting from maintenance or construction operations for highway improvements.

DATE 11/07/25 USA Communications
NAME OF COMPANY

BY 

RECOMMENDED FOR APPROVAL:

DATE _____

TAMA COUNTY ENGINEER

APPROVAL:

DATE _____

CHAIRPERSON, TAMA COUNTY BOARD OF SUPERVISORS

Adopted by Resolution 9-22-92A

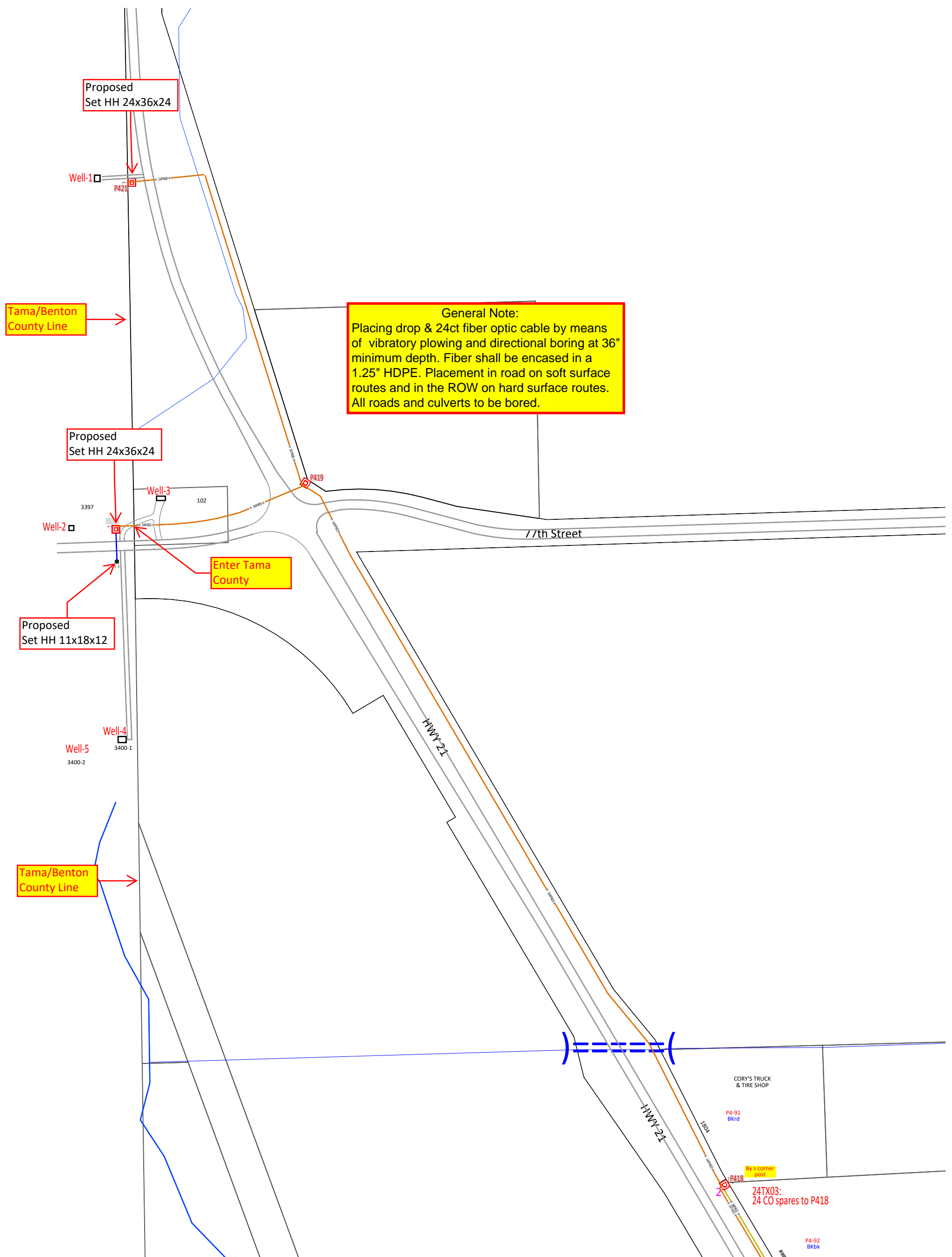

TAMA COUNTY UTILITY PERMIT APPLICATION

This is a Utility Permit Application for telecommunications, electric, gas, water and sewer utilities. The applicant agrees to comply with the following permit requirements. Compliance shall be determined by the sole discretion of the County Engineer as deemed necessary to promote public health, safety and the general welfare. These requirements shall apply unless waived in writing by the County Engineer prior to installation.

Applicant Name: Windstream Iowa Communications, LLC

Street Address: 4005 N Rodney Parham Rd

City, State & Zip Code: Little Rock, AR, 72212

Telephone Number: 870.414.3190

Contact Person: Natalia Ewing

1. Location Plan. An applicant shall file a completed location plan as an attachment to this Utility Permit Application. The location plan shall set forth the location of the proposed line on the secondary road system and include a description of the proposed installation.
2. Written or Verbal Notice. At least two working days prior to the proposed installation, an applicant shall file with the County Engineer a notice stating the time, date, location and nature of the proposed installation.
3. Inspection. The County Engineer shall provide a full-time inspector during all permitted work done by a third party contractor. The inspector shall have the right, during reasonable hours and after showing proper identification, to enter any installation site in the discharge of the inspector's official duties, and to make any inspection or test that is reasonably necessary to protect the public health, safety and welfare. The cost of providing this inspection service shall be paid by the permit holder upon submission by Tama County of a bill for such services. All requirements listed in 4. Requirements shall be met (less written exemptions) regardless of whom actually performs the work.
4. Requirements. The installation inspector shall assure that the following requirements have been met:
 - A) Construction signing shall comply with the Manual on Uniform Traffic Control Devices.
 - B) Depth – The minimum depth of cover shall be as follows:

Telecommunications....36"	Electric.....48"	
Gas.....48"	Water.....60"	Sewer.....60"

If the utility is installed in the road ditch and if the ditch has silted in above the original flowline, add the depth of silting to the "minimum depth" to obtain the required depth in a particular location.
 - C) The applicant shall use reference markers in the right of way ("R.O.W.") boundary to locate line and changes in alignment as required by the County Engineer. A permanent warning tape shall be placed one (1) foot above all underground utility lines.
 - D) All tile line locations shall be marked with references located in the R.O.W. line.
 - E) No underground utility lines shall cross over a crossroad drainage structure.
 - F) Residents along the utility route shall have uninterrupted access to the public roads. An all-weather access shall be maintained for residents adjacent to the project.
 - G) A joint assessment of the road surfacing shall be made by the applicant and the County Engineer both before and after construction. After construction, granular surfacing shall be added to the road by the applicant to restore the road to its original condition. After surfacing has been applied, the road surface shall be reviewed by the County Engineer (after the road has been saturated), to determine if additional surfacing on the roadway by the applicant is necessary.

~~HD 28104~~ damaged areas within the R.O.W. shall be repaired and restored to at least its former condition by the applicant or the cost of any repair work caused to be performed by the County will be assessed against the applicant.

- I) Areas disturbed during construction which present an erosion problem shall be solved by the applicant in a manner approved by the County Engineer.
- J) All trenches, excavations, and utilities that are knifed shall be properly tamped.
- K) All utilities shall be located between the bottom of the backslope and the bottom of the foreslope, unless otherwise approved in writing by the County Engineer prior to installation.
- L) Road crossings shall be bored. The minimum depth below the road surface shall match the minimum depth of cover for the respective utility. All entrances with culverts shall either be bored or, the utility shall be placed at least 24" below the bottom elevation of the culvert.

5. Non-Conforming Work. The County Engineer may halt the installation at any time if the applicant's work does not meet the requirements set forth in this Utility Permit.
6. Emergency Work. In emergency situations, work may be initiated by an applicant without first obtaining a Utility Permit. However, a Utility Permit must be obtained within fourteen (14) days of initiation of the work. All emergency work shall be done in conformity with the provisions of this ordinance and shall be inspected for full compliance.
7. County Infraction. Violation of this permit is a county infraction under Iowa Code section 331.307, punishable by a civil penalty of \$100 for each violation or if the infraction is a repeat offense a civil penalty not to exceed two hundred dollars for each repeat offense. Each day that a violation occurs or is permitted to exist by the applicant constitutes a separate offense.
8. Hold Harmless. The utility company shall save this County harmless of any damages resulting from the applicant's operations. A copy of a certificate of insurance naming this county as an additional named insured for the permit work shall be filed in the County Engineer's office prior to installation. The minimum limits of liability under the insurance policy shall be \$1,000,000.
9. Permit Required. No applicant shall install any lines unless such applicant has obtained a Utility Permit from the county Engineer and has agreed in writing that said installation will comply with all ordinances and requirements of the County for such work. Applicants agree to hold the County free from liability for all damage to applicant's property which occurs proximately as a result of the applicant's failure to comply with said ordinances or requirements.
10. Relocation. The applicant shall, at any time subsequent to installation of utility lines, at the applicant's own expense, relocate or remove such lines as may become necessary to conform to new grades, alignment or widening of R.O.W. resulting from maintenance or construction operations for highway improvements.

DATE 10/21/2024 Windstream Iowa Communications, LLC BY Natalia Ewing
NAME OF COMPANY

RECOMMENDED FOR APPROVAL:

DATE _____
TAMA COUNTY ENGINEER

APPROVAL:

DATE _____
CHAIRPERSON, TAMA COUNTY BOARD OF SUPERVISORS

LOCATION MAP

SARAH SILHANEK
2337 360 ST
TAMA IA
641-485-3077
Tama County

41.9271859
-92.5063702

Terminal 3120/2



WORK DESCRIPTION

Bury 325ft of two pair copper telephone cable. From Buried terminal 3120/2 Bore 40ft north under 360th st, place conduit under road. Bury 160ft east along the north side of 360th St. Bury 125ft northwest along the west side of the customer’s driveway to the NID on the house located at 2337 360th St.

PROJECT TOTALS	
PROPOSED AERIAL CATV/FIBER	
PROPOSED AERIAL RISER FOOTAGE	
PROPOSED UG CATV/FIBER	
TOTAL FOOTAGE	
TOTAL PROPOSED HANDHOLES	
TOTAL RISERS	
TOTAL PROPOSED BORE PITS	



LUFFMAN-BYERS
The Telecom Professionals
Est. 1998

Engineer: Jules Kayla
724-710-5071

Windstream OSP Mgr
DAN HOGAN
563-920-2428



WO# 133000469-50267
Location: **2337 360 ST**
Municiplity: **TAMA**
County: **Tama**
State: IA

LEGEND

BACK OF CURB	
RIGHT OF WAY	
CENTERLINE	
EDGE OF PAVEMENT	
SIDEWALK	
PROPOSED BURIED FIBER	
LANE DASHED	
LANE CONTINUED	
MEDIAN	
GAS	
SEWER	
STORM DRAIN	
WATER	
TELECOM	
ELECTRIC	
BORE PIT	
TRAFFIC SIGNAL HANDHOLE	
TRAFFIC SIGNAL	
SEWER MAINS	
PROPOSED MARKER POST	
PROPOSED GROUND ROD	
ELECTRIC MANHOLE	
PROPOSED HANDHOLE (32"X48")	
EXISTING SLACKLOOP-150'	
ELECTRIC HH	
STORM INLET	
TREE SYMBLE	
EXISTING POLES	
RISER	

WATER HYDRANT
WATER VALVE
WATER METER
GAS VALVE
STORM MANHOLE
STREET LIGHT
TELECO MANHOLE
EX.HANDHOLE
GUARD RAILING



GENERAL NOTES

1. GENERAL NOTES SHALL APPLY TO ALL DRAWINGS.
 2. ALL WORK SHALL COMPLY WITH APPLICABLE STATE, COUNTY, & LOCAL REGULATORY AGENCIES, INCLUDING BUT NOT LIMITED TO OSHA, DOT, ESL.
 3. THE CONTRACTOR SHALL CONTACT THE ADJACENT PROPERTY OWNERS A MINIMUM OF 12 HOURS IN ADVANCE OF CONSTRUCTION AT THE WORK SITE.
 4. ALL TRAFFIC CONTROL DEVICES SHALL BE IN PLACE BEFORE WORK IS STARTED. DEVICES NO LONGER REQUIRED SHALL BE REMOVED AS SOON AS POSSIBLE.
 5. PEDESTRIAN TRAFFIC AREAS MUST BE MAINTAINED AT ALL TIMES. PEDESTRIANS MAY NOT BE REROUTED ONTO PRIVATE PROPERTY OR INTO STREETS. NO EQUIPMENT OR MATERIALS SHALL BE STORED OR PERMITTED TO STAND UNPROTECTED WHERE TRAFFIC IS MAINTAINED.
 6. NO EQUIPMENT OR MATERIALS SHALL BE STORED ON ROAD SURFACE DURING NON-WORKING PERIODS.
 7. NO EQUIPMENT OR MATERIALS SHALL BE STORED ON S/W AT ANY TIME.
 8. EXCAVATION MATERIAL SHALL BE STORED AWAY FROM THE PAVED ROADWAY. ALL SPILLED MATERIAL WILL BE REMOVED IMMEDIATELY.
 9. EXISTING SIGNS, DELINEATORS, GUARDRAILS, MARKERS, TREES, SHRUBS, FENCES, WALKS, STEPS, ESL., THAT ARE DISTURBED BY THIS CONSTRUCTION SHALL BE REPLACED OR RESTORED TO THEIR ORIGINAL CONDITION OR TO THE SATISFACTION OF THE INSPECTING ENGINEER, PROPERTY OWNER, CITY, COUNTY, OR STATE AND/OR ANY OTHER AGENCY HAVING AUTHORITY/JURISDICTION.
 10. CITY, COUNTY, OR STATE ROAD SIGNS, DELINEATORS, GUARDRAILS, ESL. SHALL NOT BE REMOVED. WRITTEN PERMISSION SHALL BE REQUIRED PRIOR TO ANY EXCAVATION IN THIS AREA.
 11. ALL WORK SHALL BE PERFORMED IN ACCORDANCE WITH THE CITY, COUNTY, OR STATE SPECIFICATIONS AND STANDARDS.
 12. ALL PERSONS WHO FLAG TRAFFIC ON STATE RIGHT-OF-WAY MUST BE CERTIFIED.
 13. ALL SURFACE AND SUBSURFACE RESTORATION IS TO BE IDENTICAL TO THE ADJACENT UNDISTURBED AREAS.
 14. THE CONTRACTOR IS RESPONSIBLE FOR ANY UTILITY DAMAGES. WHEN ANY PERSON DAMAGES A UTILITY LINE OR PROTECTIVE COATING DURING EXCAVATION OR DEMOLITION THE ONSITE CITY INSPECTOR AND THE AFFECTED UTILITY WILL BE NOTIFIED.
 16. ON ALL WORK ASSOCIATED WITH DOT PROJECTS THE RESIDENT ADMINISTRATOR FOR DOT MUST BE NOTIFIED AT LEAST 48 HRS BEFORE STARTING WORK.
 17. CONTRACTOR IS RESPONSIBLE FOR ALL COMPACTING AND SEDIMENT CONTROL REGULATIONS.
- ** NO HANDHOLES ARE TO BE PLACED WITHIN DITCH LINES.

CONSTRUCTION NOTES

1. ALL EXCAVATIONS WILL HAVE FIBER OPTIC WARNING TAPE INSTALLED A MINIMUM OF 2' BELOW FINAL GRADE.
2. WHENEVER DIRECTIONAL BORING IS UTILIZED TO INSTALL CONDUITS ALL EXCAVATIONS SHALL BE BACKFILLED PER FDOT SPECIFICATIONS.
3. VERIFICATION OF THE LOCATION OF ALL UTILITY CROSSINGS IS THE SUBCONTRACTOR'S RESPONSIBILITY. HAND DIG WHERE REQUIRED. ALL KNOWN UTILITIES MUST BE "TEST PITTED".
4. CONTACT FLORIDA 811 72 HOURS IN ADVANCE OF CONSTRUCTION FOR LOCATION OF BURIED UTILITIES.
5. IT IS THE RESPONSIBILITY OF THE CONTRACTOR TO HAVE ALL FDOT TRAFFIC LOOPS LOCATED.
6. CONFIRM WITH WINDSTREAM, WITH FDOT CORRESPONDENCE, THAT ALL TRAFFIC LOOP LOCATIONS HAVE BEEN COORDINATED FOR MARKING.
7. AT THE END OF EACH WORK DAY CONDUIT CAPS WILL BE PLACED ON ALL VACANT DUCTS.
8. A MINIMUM BENDING RADIUS OF 24" FOR FIBER CABLE WILL BE ADHERED TO.
9. MAXIMUM CABLE INSTALLATION TENSION SHALL NOT EXCEED 600 POUNDS.
10. THE CONTRACTOR SHALL BE RESPONSIBLE FOR THE REMOVAL AND STORAGE OF ALL SHRUBBERY TO BE REPLACED.
11. RESTORATION OF THE CONSTRUCTION AREA TO ORIGINAL OR BETTER CONDITION SHALL BE THE RESPONSIBILITY OF THE CONTRACTOR.
12. PLACE 6" OF 3/4" CRUSHED ROCK IN THE BOTTOM OF THE PIT PRIOR TO PLACING THE HANDHOLE.
13. ALWAYS HAND DIG WITHIN 2' OF UTILITIES.
14. PLACE A COIL OF SLACK IN EACH HANDHOLE/MANHOLE AS SPECIFIED.
15. EXCAVATE OUTSIDE THE DRIP LINE OF ALL TREES TO PREVENT ROOT DAMAGE.
16. CONSTRUCTION MATERIALS AND STAGING AREAS ARE NOT PERMITTED WITHIN 25' BUFFER ZONE OF WETLANDS, CREEKS, AND STREAMS.
17. THE CURB AND GUTTER IS NOT TO BE DISTURBED WITHOUT PRIOR APPROVAL.
18. IN THE EVENT THAT IT IS NECESSARY TO REMOVE ANY PORTION OF THE CURB AND GUTTER, IT IS TO BE REPLACED SEAM TO SEAM IN A MATCHING CONFIGURATION TO THE ADJACENT CURB AND GUTTER.
19. ALL R/W SHOWN ARE BASED ON CURRENT COUNTY TAX/GIS MAPS. PLACING CONTRACTOR TO VERIFY R/W PRIOR TO CONSTRUCTION AND NOTIFY SOURCE ONE CORP. OF ANY DISCREPANCIES SO CORRECTIONS CAN BE MADE AND REVISED CONSTRUCTION/ PERMIT DRAWINGS CAN BE SUBMITTED.
20. THE LOCATION OF THE EXISTING UTILITIES REFLECTED ON THESE PLANS ARE ONLY AN ESTIMATION AND NEED TO BE LOCATED PRIOR TO CONSTRUCTION.

EROSION AND SETTLEMENT

1. MATERIAL RESULTING FROM EXCAVATION WILL NOT BE PLACED IN SUCH A MANNER THAT IT IS DISPERSED BY CURRENT OR OTHER FORCES. THE MATERIAL SHOULD BE COLLECTED AND CONTAINED AT ONE SITE AS APPROPRIATE.
2. APPROPRIATE SILTATION AND EROSION CONTROLS WILL BE USED AND MAINTAINED IN EFFECTIVE OPERATING CONDITION DURING CONSTRUCTION, AND ALL EXPOSED SOIL AND FILLS WILL BE PERMANENTLY STABILIZED AT THE EARLIEST PRACTICABLE DATE.
3. SEDIMENT CONTROL FENCE (SILT FENCE) SHOULD BE INSTALLED AND MAINTAINED FOR THE DURATION OF THE CONSTRUCTION. SILT FENCE WILL BE INSTALLED ALONG AND WITHIN THE RIGHT-OF-WAY LINE (12 FT. AWAY FROM THE EDGE OF THE RIGHT-OF-WAY), IF A BODY OF WATER OR POTENTIAL WETLAND IS LOCATED WITHIN 60 FT. FROM THE EDGE OF THE RIGHT-OF-WAY. ANY OTHER SITUATIONS WILL BE APPROVED BY ENGINEER.
4. WHEN CONSTRUCTING IN CITY LIMITS, ALL ROADWAY DRAINS, SUCH AS INLETS NEAR CURBS OR DROP INLETS ON ROADWAYS WHICH ARE LOCATED WITHIN THE RIGHT-OF-WAY, SHALL BE PROTECTED WITH TYPICAL INLET SEDIMENT FILTERS. THESE FILTERS WILL BE REMOVED IMMEDIATELY UPON COMPLETION OF CONSTRUCTION.
5. ALL CABLE MARKERS TO BE PLACED AS FAR BACK TO RIGHT-OF-WAY LINE AS POSSIBLE.
6. ANY DISTURBED AREA WILL BE RESEEDED WITH NATIVE GRASS SEED, AND SEDIMENT CONTROL FENCE SHOULD REMOVED IMMEDIATELY UPON COMPLETION OF CONSTRUCTION.
7. ALL HARD SURFACED DRIVEWAYS TO BE DIRECTIONAL BORED.
8. NO STAGING AREAS OR TEMPORARY ACCESS ROADS WILL BE PLACED IN WETLANDS.
9. HEAVY EQUIPMENT WORKING IN WETLANDS WILL BE PLACED ON MATS OR LOW GROUND PRESSURE EQUIPMENT USED DURING CONSTRUCTION TO LIMIT SOIL DISTURBANCE TO THE MINIMUM AREA REQUIRED TO INSTALL THE UTILITY.
10. EXCESS MATERIAL WILL BE REMOVED FROM THE WETLAND AND PLACED ON UPLAND AREAS IMMEDIATELY UPON COMPLETION OF CONSTRUCTION.



LUFFMAN-BYERS
The Telecom Professionals

Est. 1998

Engineer: Jules Kayla
724-710-5071

Windstream OSP Mgr
DAN HOGAN
563-920-2428



WO# 133000469-50267

Location: **2337 360 ST**
Municipality: **TAMA**
County: **Tama**
State: **IA**

Drawing
3 of 5

PERMIT REQUEST #44939

EST FOOTAGE IN COUNTY ROW=200ft

CONSTRUCTION UNITS

BM60(1)(1 ¼)P=40 Bore under road,place conduit, pull drop through bore

SEB2X22(B) 185 Bury two pair copper drop

SARAH SILHANEK
2337 360 ST
TAMA IA
641-485-3077
Tama County
41.9271859
-92.5063702
Terminal 3120/2

Kyle Kucera e0189459 641-481-3237
Place Buried Drop: 2PR Est Ft:325



Comments / Notes to Contractor

NID is on north side of house Flags and paint are in place on the route of the cable Cable cannot be tempted The ped is across the road from house to the south Flags are next to ditch to show you where ped is at

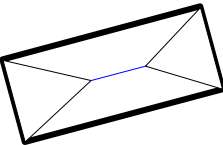

Bury 125ft northwest along the west side of the customer's driveway to the NID on the house located at 2337 360th St.

Bury 160ft east along the north side of 360th St.

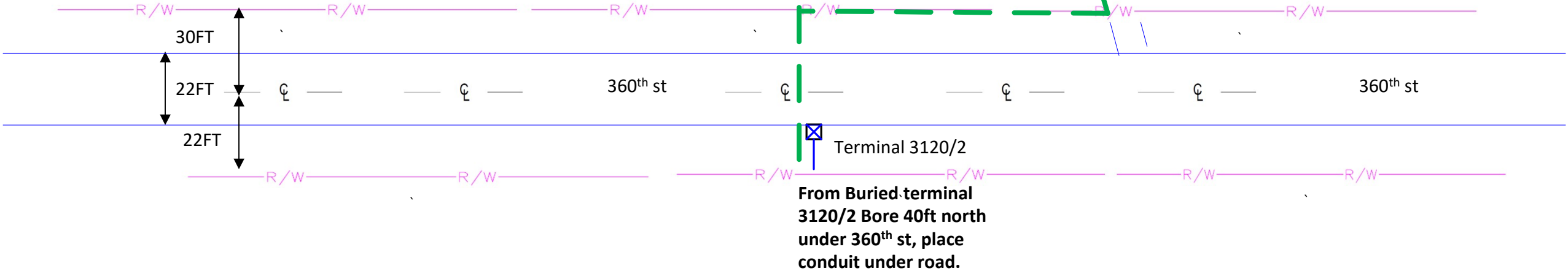

WO# 133000469-50267

Location: [2337 360 ST](#)

Municipality: [TAMA](#)

County: [Tama](#)

State: IA

360th St 1756'
UEF 6-19
HA,39-44

360th St 3120 / 2

360th St

2076'
UEF 6-19
HA,39-43
XD,6

360th St

60ft

41.92615 -92.50653 Degrees

RESOLUTION 11-10-2025B

A Resolution Establishing an Indefinite Moratorium on Battery Storage Projects in Tama County, IA

WHEREAS, the Tama County Board of Supervisors is vested with the authority to protect the public health, safety, and general welfare of the residents of Tama County; and

WHEREAS, the County currently lacks a specific ordinance or comprehensive regulatory framework governing the siting, development, and operation of battery storage projects; and

WHEREAS, the Board recognizes the need to develop an ordinance to address the unique characteristics and potential impacts of battery storage projects; and

WHEREAS, the preservation of Tama County's agricultural lands, rural character, and natural resources is of vital importance to the well-being and sustainability of the county; and

WHEREAS, the Board has identified concerns related to battery storage projects, including but not limited to fire hazards, safety risks, adequacy of emergency response preparedness, potential for environmental contamination, appropriate setbacks from properties and sensitive uses, and visual impacts on the landscape; and

WHEREAS, it is essential to balance the property rights of landowners with the County's responsibility to protect public health, safety, and welfare, and to ensure that any future battery storage projects are thoroughly evaluated and appropriately regulated and;

WHEREAS, The Tama County Zoning Commission is the appropriate body to develop a comprehensive ordinance addressing the siting and regulation of battery storage projects.

NOW, THEREFORE, BE IT RESOLVED by the Tama County Board of Supervisors as follows:

- The Board hereby establishes an indefinite moratorium on the acceptance, review, or approval of any applications or permits for new battery storage projects within Tama County, effective immediately upon adoption of this Resolution.
- This moratorium applies to all proposed battery storage facilities, regardless of size, technology, or location, that are not currently permitted or under construction as of the effective date of this Resolution.
- The moratorium shall remain in effect until:
 - A comprehensive land use plan is adopted by Tama County; and
 - The Tama County Zoning Commission drafts and the Board of Supervisors enacts a battery storage ordinance providing for the appropriate regulation, siting, and operation of battery storage projects.
- The Tama County Zoning Commission is hereby directed to work on the development of a comprehensive battery storage ordinance.